

2-Phase Stepping Motor Standard Type **PH299** Step Angle 1.8°

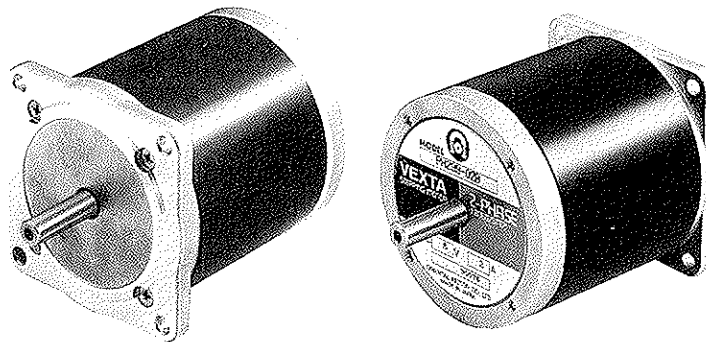

■ Specifications (at two phase excitation)

Model	Holding Torque kgcm	Current per Phase A/Phase	Voltage V	Resistance per Phase Ω /Phase	Rotor Inertia J gcm ²
Single Shaft PH299-01	22	4	3	0.75	1100
Double Shaft PH299-01B					
Single Shaft PH299-02	22	2	6	3	1100
Double Shaft PH299-02B					

■ Dimensions Scale 1:4, unit = mm

● Single Shaft Weight 2.5kg

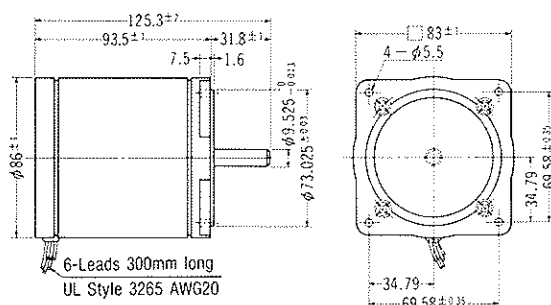

● Double Shaft Weight 2.5kg

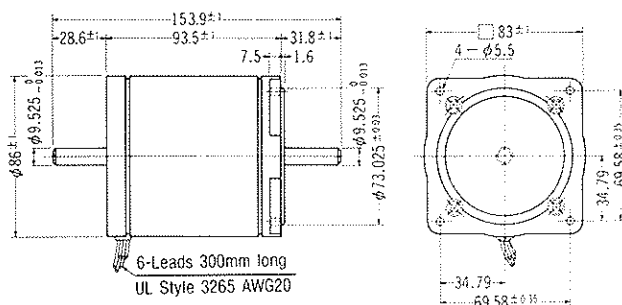

■ Speed-Torque Characteristics

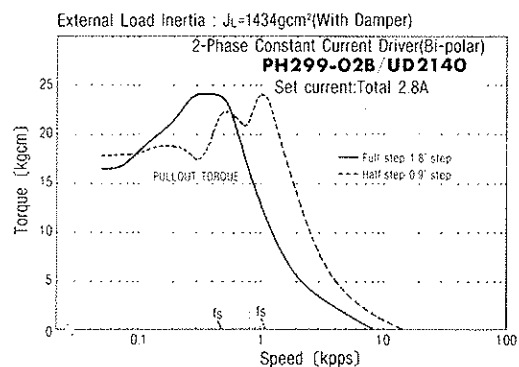
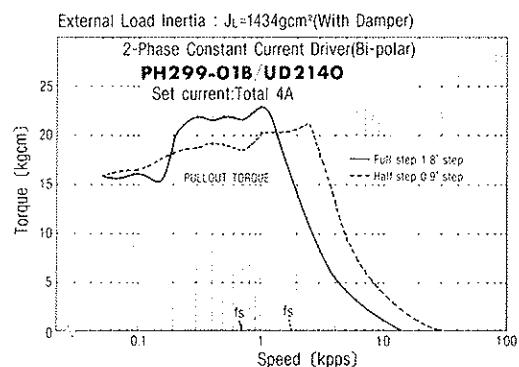

Caution: Depending on drive conditions, motor may become extremely hot. Operate such that the temperature of motor case does not exceed 100°C.

PRODUCT SPECIFICATIONS OF 2-PHASE STEPPING MOTORS

■ Specifications

Model	Single Shaft Double Shaft	Basic Step Angle	Holding Torque kgcm	Current per Phase A/Phase	Voltage V	Resistance per Phase Ω /Phase	Rotor Inertia J gcm ²	Weight kg	Page
PX243-01A		1.8°	1.1	0.95	4	4.2	16	0.2	B-112
PX243-01B									
PX243-02A		1.8°	1.1	0.4	9.6	24	16	0.2	B-112
PX243-02B									
PX243-03A		1.8°	1.1	0.31	12	38.5	16	0.2	B-112
PX243-03B									
PX244-02A		1.8°	1.6	0.8	6	7.5	24	0.25	B-113
PX244-02B									
PX244-03A		1.8°	1.6	0.4	12	30	24	0.25	B-113
PX244-03B									
PX244-04A		1.8°	1.6	0.2	24	120	24	0.25	B-113
PX244-04B									
PX245-01A		1.8°	2.2	1.2	4	3.3	35	0.33	B-114
PX245-01B									
PX245-02A		1.8°	2.2	0.8	6	7.5	35	0.33	B-114
PX245-02B									
PX245-03A		1.8°	2.2	0.4	12	30	35	0.33	B-114
PX245-03B									
PH264-01		1.8°	2.9	1.1	4	3.6	57	0.4	B-115
PH264-01B									
PH264-02		1.8°	2.9	0.4	12	30	57	0.4	B-115
PH264-02B									
PH264-03		1.8°	2.9	0.2	24	120	57	0.4	B-115
PH264-03B									
PH266-01		1.8°	6	1.2	6	5	135	0.6	B-116
PH266-01B									
PH266-02		1.8°	6	0.6	12	20	135	0.6	B-116
PH266-02B									
PH266-03		1.8°	6	0.3	24	80	135	0.6	B-116
PH266-03B									
PH268-21		1.8°	9	1.5	5.4	3.6	200	0.95	B-117
PH268-21B									
PH2610-01		1.8°	10.8	1.88	6	3.2	320	1.2	B-118
PH2610-01B									
PH296-01		1.8°	12.5	4.5	1.8	0.4	560	1.5	B-119
PH296-01B									
PH296-02		1.8°	12.5	1.25	5.5	4.4	560	1.5	B-119
PH296-02B									
PH299-01		1.8°	22	4	3	0.75	1100	2.5	B-120
PH299-01B									
PH299-02		1.8°	22	2	6	3	1100	2.5	B-120
PH299-02B									

* The value given for holding torque is the value operated with rated voltage and two phase excitation.

■ Windings

